

XHLO Full Dimensions
Male Adapter
37° Flare / ORFS

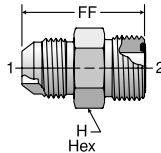

TUBE FITTING PART #	END SIZE		FF (in.)	H HEX (in.)	STANDARD Dynamic Pressure (x 1,000 PSI)	
	1 (in.)	2 (in.)			-S	-SS
	4 XHLO	1/4			1/4	1.25
6 XHLO	3/8	3/8	1.34	3/4	6.0	
8 XHLO	1/2	1/2	1.55	7/8	6.0	7.2
10 XHLO	5/8	5/8	1.83	1 1/16	5.0	
12 XHLO	3/4	3/4	2.05	1 1/4	5.0	
16 XHLO	1	1	2.16	1 1/2	4.5	
20 XHLO	1 1/4	1 1/4	2.29	1 3/4	4.0	4.8
24 XHLO	1 1/2	1 1/2	2.48	2 1/8	3.0	

LOHX6 Full Dimensions
Swivel Adapter
37° Flare Swivel / ORFS

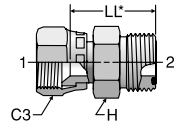

*LL – End to base of flare

TUBE FITTING PART #	END SIZE		C3 HEX (in.)	H HEX (in.)	LL Ref. (in.)	STANDARD Dynamic Pressure (x 1,000 PSI)	
	1 (in.)	2 (in.)				-S	-SS
	4 LOHX6	1/4				1/4	9/16
6 LOHX6	3/8	3/8	11/16	3/4	1.06	5.0	
8 LOHX6	1/2	1/2	7/8	7/8	1.21	5.0	6.0
10 LOHX6	5/8	5/8	1	1 1/16	1.40	5.0	
12 LOHX6	3/4	3/4	1 1/4	1 1/4	1.48	5.0	
16 LOHX6	1	1	1 1/2	1 1/2	1.64	3.6	
20 LOHX6	1 1/4	1 1/4	2	1 3/4	1.77	3.6	

XHL6 Full Dimensions
Male Swivel Adapter
ORFS Swivel / 37° Flare

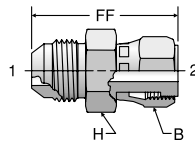

TUBE FITTING PART #	END SIZE		B HEX (in.)	FF (in.)	H HEX (inch) (in.)	STANDARD Dynamic Pressure (x 1,000 PSI)	
	1 (in.)	2 (in.)				-S	-SS
	4 XHL6	1/4				1/4	11/16
6 XHL6	3/8	3/8	13/16	1.61	3/4	6.0	
8 XHL6	1/2	1/2	15/16	1.90	7/8	6.0	7.2
10 XHL6	5/8	5/8	1 1/8	2.20	1 1/16	5.0	
12 XHL6	3/4	3/4	1 3/8	2.50	1 1/4	5.0	
16 XHL6	1	1	1 5/8	2.66	1 1/2	4.5	
20 XHL6	1 1/4	1 1/4	1 7/8	2.80	1 11/16	4.0	

LOEX6 Full Dimensions
Swivel Elbow
ORFS / 37° Flare Swivel

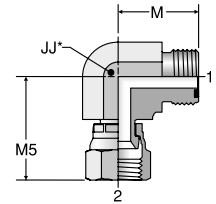

* JJ – Across wrench flats

TUBE FITTING PART #	END SIZE		JJ (in.)	M (in.)	M5 (in.)	STANDARD Dynamic Pressure (x 1,000 PSI)	
	1 (in.)	2 UN/UNF-2B				-S	-SS
	4 LOEX6	1/4				1/4	9/16
6 LOEX6	3/8	3/8	3/4	0.98	1.25	5.0	
8 LOEX6	1/2	1/2	3/4	1.10	1.38	5.0	
10 LOEX6	5/8	5/8	1 1/16	1.31	1.63	5.0	
12 LOEX6	3/4	3/4	1 3/16	1.47	1.80	5.0	
16 LOEX6	1	1	1 7/16	1.64	2.00		
20 LOEX6	1 1/4	1 1/4	1 5/8	1.76	2.31	3.6	
24 LOEX6	1 1/2	1 1/2	1 7/8	1.92	2.59		

Dimensions and pressures for reference only, subject to change.

